

PC PENDANT

DESIGN BY PIERRE CHARPIN



Pierre Charpin's PC Pendants is a collection of refined suspension lighting that can be used independently or clustered together. The pendants are constructed in anodised aluminium, which makes the surface more resistant to corrosion. The light source in each pendant lamp is hidden by a removable polycarbonate moulded diffuser, creating both a soft directional output of light and determining the form of the lamp itself. The PC Pendants are available in a variety of sizes and colours, and are suitable for both contract and domestic markets.

PRODUCT DETAILS

- / Part of a progressive and technologically advanced lighting collection.
- / A family of refined pendants, task lights, table and portable lamps.
- / CE approved.
- / Designed for use with a replaceable standard retro fit LED dimmable bulb.
- / The fitting can be used in conjunction with a number of standard wall mounted dimming control units.
- / Suitable for both private and office environments.

HAY

MATERIAL

SHADE / Anodised spun aluminium shade.

DIFFUSER / Injection moulded translucent polycarbonate diffuser.

CABLE / Braided fabric cable with a PVC insulation.
Please note that the cable is black for all colour options.

COLOUR & FINISH

Please note that the colour codes are indicative.

- Available in 4 different colours.
/ Soft black anodised (RAL 9004)
/ Emerald green anodised (RAL 6002)
/ Blush red anodised (PANTONE 492 U)
/ Aluminium anodised

COLOUR

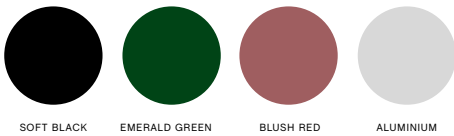

COLOUR \ SIZE	Small	Medium	Large
Soft black	•	•	•
Emerald green	•	•	
Blush red	•		
Aluminium	•	•	•

DIMENSIONS

PC PENDANT SMALL
/ WIDTH 25 cm / 9.8"
/ DEPTH 25 cm / 9.8"
/ HEIGHT 14,5 cm / 5.7"

PC PENDANT MEDIUM
/ WIDTH 40 cm / 15.7"
/ DEPTH 40 cm / 15.7"
/ HEIGHT 20,5 cm / 8.1"

PC PENDANT LARGE
/ WIDTH 60 cm / 23.6"
/ DEPTH 60 cm / 23.6"
/ HEIGHT 28 cm / 11"

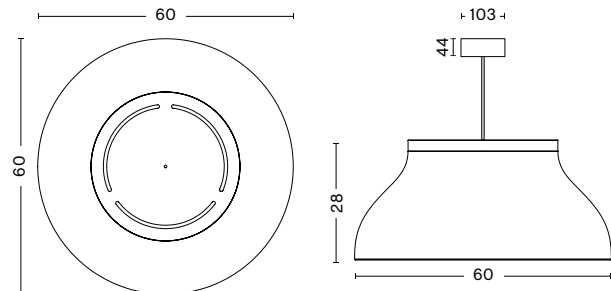
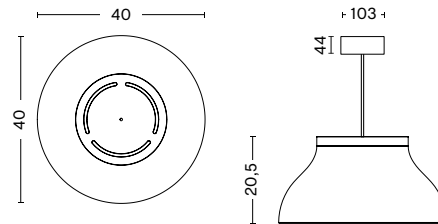
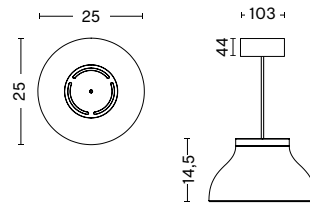

TECHNICAL SPECIFICATION

SMALL

- / LIGHT SOURCE / 3 x G9 / LED
- / POWER* (watts) / Max 5W (per fitting)
- / FLUX* (lumens) / 625lm
- / CCT* (kelvin) / 2700k
- / CRI* (1-100) / 85
- / DIMMABLE / Yes
- / POWER SUPPLY / 220-240V AC at 50/60Hz
- / CORD LENGTH / 400 cm
- / SWITCH / No
- / BULB SPEC. / 3 x LED G9 Max 5W 300 - 600lm 2800k
Dimmable or Non Dimmable

*Bulb sold separately. Photometrics and the specification shown is taken using our recommended LED G9 bulbs fitted in the production luminaire

CERTIFICATIONS

/ CE approved: this product has been assessed and complies with the essential requirements of the relevant European directives.



Tested according to the following European EN / IEC standards which relate specifically to electrical lighting products including:

- / EN 55015:2013 (radio disturbance)
- / EN 61547:2009 (EMC immunity)
- / EN 61000-3-2:2014 (EMC compatibility)
- / EN 61000-3-3:2013 (EMC compatibility)
- / EN 60598-2-4:1997 (portable luminaires)
- / EN 60598-1:2015 (general requirements)
- / EN 62493:2010 (human exposure to EMC)

PHOTOMETRICS

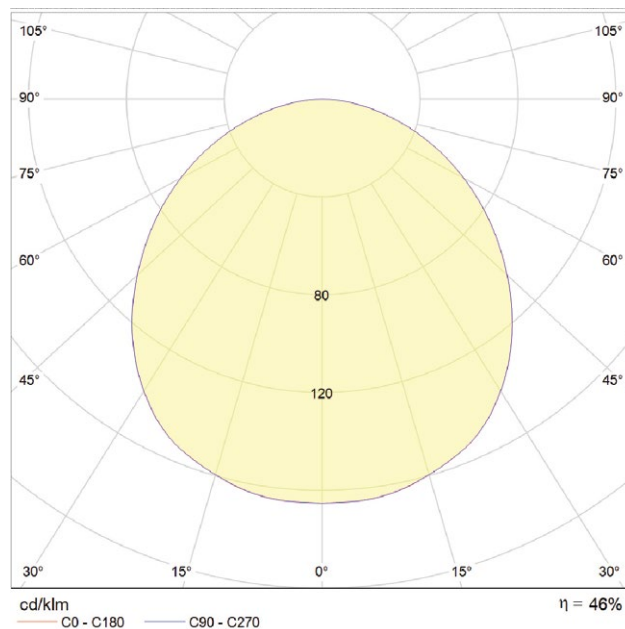

DOWNLOADS

2D files, 3D files and packshots are available in our imagebank at hay.com.

Care and maintenance instructions and CE attestation of conformity certificates are available at hay.com

An overview of the complete Hay lighting collection and accessories, can be found at hay.dk/en/contract/products/lighting

TECHNICAL SPECIFICATION

MEDIUM

- / LIGHT SOURCE / 1 x E27 / LED
- / POWER* (watts) / Max 13W
- / FLUX* (lumens) / 900lm
- / CCT* (kelvin) / 2700k
- / CRI* (1-100) / 85
- / DIMMABLE / Yes
- / POWER SUPPLY / 220-240V AC at 50/60Hz
- / CORD LENGTH / 400 cm
- / SWITCH / No
- / BULB SPEC. / 1 x LED E27 Max 13W 1000 - 1400lm 2700k
Dimmable or Non Dimmable (A series styles, G series or 'globe' styles are not recommended)

*Bulb sold separately. Photometrics and the specification shown is taken using our recommended LED E27 bulb fitted in the production luminaire

CERTIFICATIONS

/ CE approved: this product has been assessed and complies with the essential requirements of the relevant European directives.



Tested according to the following European EN / IEC standards which relate specifically to electrical lighting products including:

- / EN 55015:2013 (radio disturbance)
- / EN 61547:2009 (EMC immunity)
- / EN 61000-3-2:2014 (EMC compatibility)
- / EN 61000-3-3:2013 (EMC compatibility)
- / EN 60598-2-4:1997 (portable luminaires)
- / EN 60598-1:2015 (general requirements)
- / EN 62493:2010 (human exposure to EMC)

PHOTOMETRICS

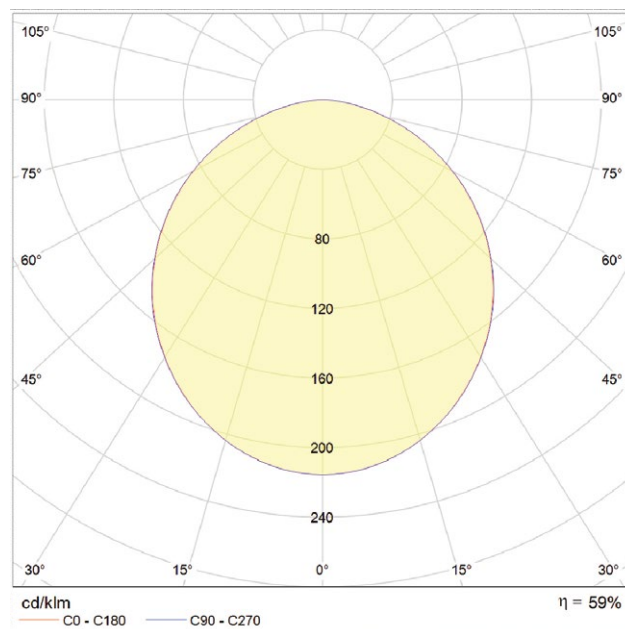

DOWNLOADS

2D files, 3D files and packshots are available in our imagebank at hay.com.

Care and maintenance instructions and CE attestation of conformity certificates are available at hay.com

An overview of the complete Hay lighting collection and accessories, can be found at hay.dk/en/contract/products/lighting

TECHNICAL SPECIFICATION

LARGE

- / LIGHT SOURCE / 3 x E27 / LED
- / POWER* (watts) / Max 13W (per fitting)
- / FLUX* (lumens) / 2400lm
- / CCT* (kelvin) / 2700k
- / CRI* (1-100) / 85
- / DIMMABLE / Yes
- / POWER SUPPLY / 220-240V AC at 50/60Hz
- / CORD LENGTH / 400 cm
- / SWITCH / No
- / BULB SPEC. / 3 x LED E27 Max 13W 1000 - 1400lm 2700k
Dimmable or Non Dimmable (A series styles, G series or 'globe' styles are not recommended)

*Bulb sold separately. Photometrics and the specification shown is taken using our recommended LED E27 bulbs fitted in the production luminaire

CERTIFICATIONS

/ CE approved: this product has been assessed and complies with the essential requirements of the relevant European directives.



Tested according to the following European EN / IEC standards which relate specifically to electrical lighting products including:

- / EN 55015:2013 (radio disturbance)
- / EN 61547:2009 (EMC immunity)
- / EN 61000-3-2:2014 (EMC compatibility)
- / EN 61000-3-3:2013 (EMC compatibility)
- / EN 60598-2-4:1997 (portable luminaires)
- / EN 60598-1:2015 (general requirements)
- / EN 62493:2010 (human exposure to EMC)

PHOTOMETRICS

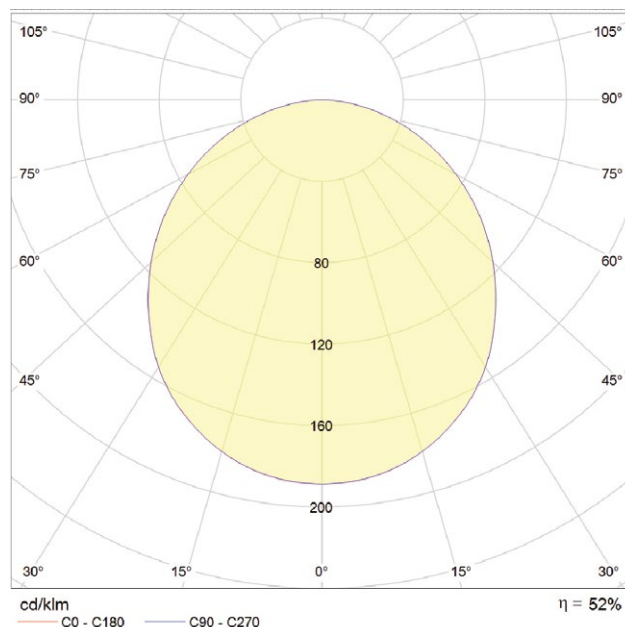

DOWNLOADS

2D files, 3D files and packshots are available in our imagebank at hay.com.

Care and maintenance instructions and CE attestation of conformity certificates are available at hay.com

An overview of the complete Hay lighting collection and accessories, can be found at hay.dk/en/contract/products/lighting

HAY